

CITY MAP

LOWRY

WALWORTH COUNTY - SOUTH DAKOTA

T 121 N - R 76 W

SCALE



POP. 10 (2020)

2021

PREPARED BY

SOUTH DAKOTA DEPARTMENT OF TRANSPORTATION

IN COOPERATION WITH

U.S. DEPARTMENT OF TRANSPORTATION FEDERAL HIGHWAY ADMINISTRATION

ALL STREET RIGHT OF WAY 66 FT.

ALLEYS 16 FT.

(UNLESS OTHERWISE INDICATED)

(UNOFFICIAL EDITION)

LEGEND

U.S. NUMBERED HIGHWAY		
U.S. NUMBERED INTERSTATE HIGHWAY		
STATE NUMBERED HIGHWAY		
STREAMS, CREEKS, AND OTHER WATERWAYS		
CANALS, LATERALS, IRRIGATION DITCHES WITH DIRECTION OF FLOW		
HARD SURFACE		
GRAVEL SURFACE		
EARTH SURFACE		
UNIMPROVED		
TRAIL		
GRADE		
CENTRAL BUSINESS DISTRICT		
TOWN CENTER (COUNTY SEAT)		
CITY LIMITS		
RAILROAD		
GRAIN ELEVATOR		
SWIMMING POOL		
BALL FIELD		
CEMETERY		
HOSPITAL		
HIGHWAY GARAGE (C-COUNTY, S-STATE)		
POST OFFICE		
CHURCH		
LIBRARY		
POWER PLANT		
WATER SUPPLY STAND PIPE OR TANK		
MUNICIPAL BUILDING		
BULK PLANT		
FIREHALL		
SCHOOLHOUSE		
TOWNHALL		
MUSEUM		
POLICE STATION		
AIRPORT		

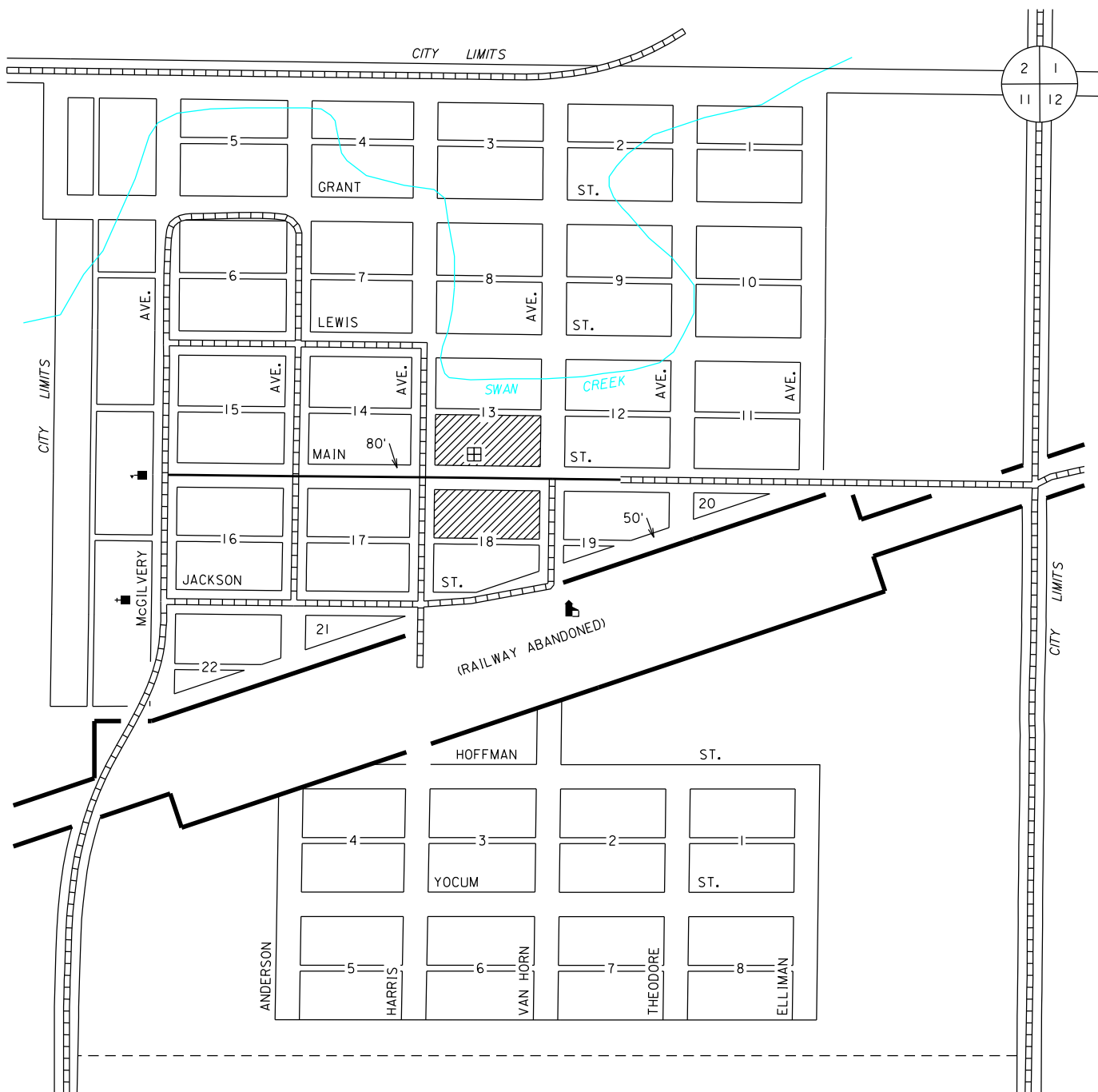

RESTRICTION OF LIABILITY: The South Dakota Department of Transportation makes no claims, promises or guarantees about the accuracy, completeness, or adequacy of the data and expressly disclaims liability for errors and omissions of the data content. No warranty of any kind, implied, expressed or statutory, including but not limited to the warranties of non-infringement of third party rights, title, merchantability and fitness for a particular purpose is given with respect to this data.