  
 CITY MAP  
**WINNER**  
 TRIPP COUNTY - SOUTH DAKOTA  
 T 99 N - R 76 W

SCALE  
 0 300ft.  
 POP. 2021 CENSUS  
 2021  
 PREPARED BY  
 SOUTH DAKOTA  
 DEPARTMENT OF TRANSPORTATION  
 IN COOPERATION WITH  
 U.S. DEPARTMENT OF TRANSPORTATION  
 FEDERAL HIGHWAY ADMINISTRATION  
 ALL STREET WIDTHS OF 60' TO 80'  
 ALLEYS 20 FT.  
 UNLESS OTHERWISE INDICATED  
 UNOFFICIAL EDITION

- LEGEND**
- U.S. NUMBERED HIGHWAY
  - U.S. NUMBERED INTERSTATE HIGHWAY
  - STATE NUMBERED HIGHWAY
  - STREAMS, CREEKS, AND OTHER WATERWAYS
  - CANALS, LATERALS, IRRIGATION DITCHES WITH DIRECTION OF FLOW
  - HAIR SURFACE
  - GRAVEL SURFACE
  - EARTH SURFACE
  - UNIMPROVED
  - TRAIL
  - GRADE
  - CENTRAL BUSINESS DISTRICT
  - TOWN CENTER (COUNTY SEAT)
  - CITY LIMITS
  - RAILROAD
  - GRAIN ELEVATOR
  - SWIMMING POOL
  - BALL FIELD
  - CEMETERY
  - HOSPITAL
  - HIGHWAY GARAGE (IC-COUNTY, S-STATE)
  - POST OFFICE
  - CHURCH
  - LIBRARY
  - POWER PLANT
  - WATER SUPPLY STAND PIPE OR TANK
  - MUNICIPAL BUILDING
  - BULK PLANT
  - FIREHALL
  - SCHOOLHOUSE
  - TOWNHALL
  - MUSEUM
  - POLICE STATION
  - AIRPORT

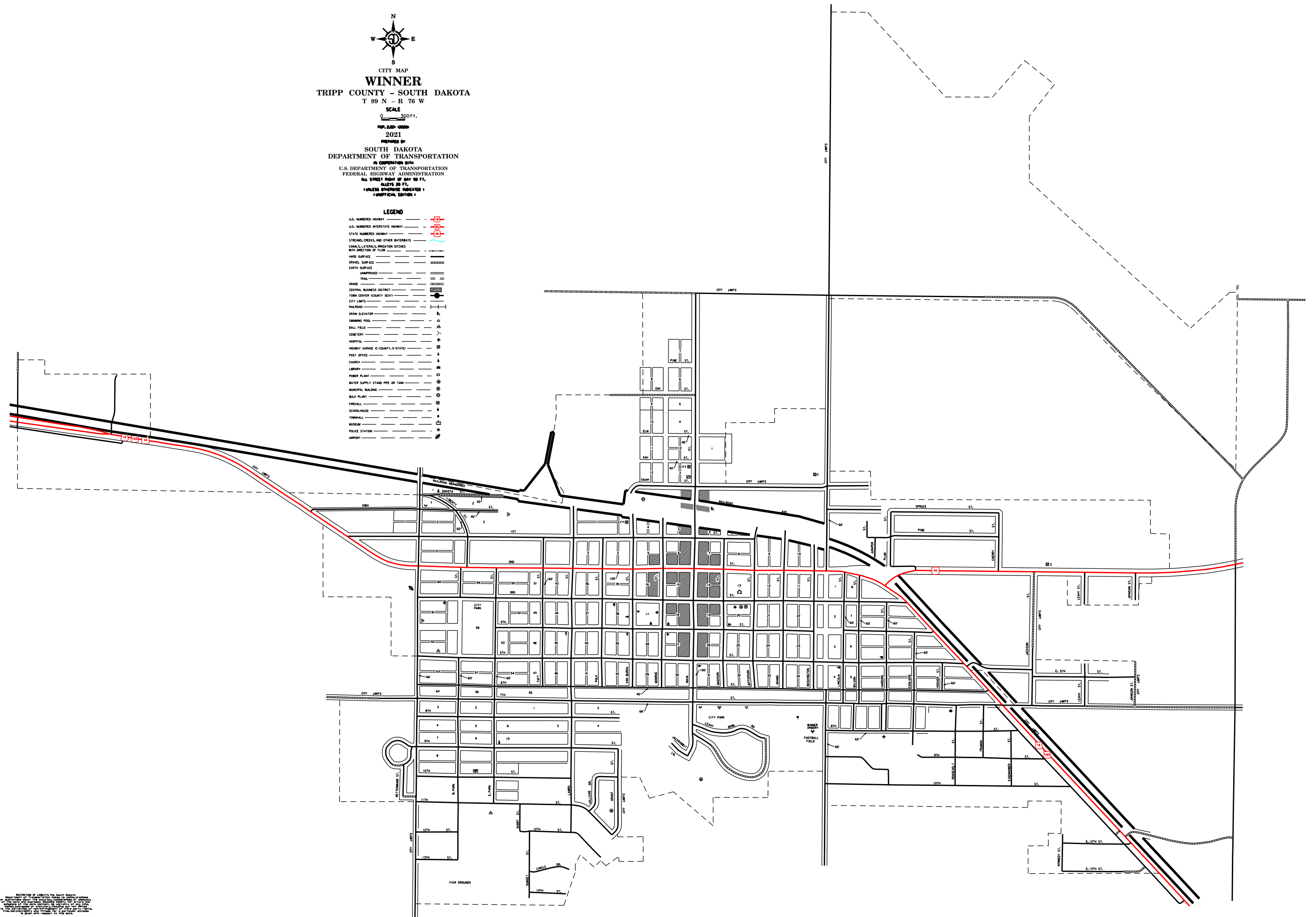

REPRODUCTION OF THIS MAP IS PROHIBITED WITHOUT THE WRITTEN PERMISSION OF THE SOUTH DAKOTA DEPARTMENT OF TRANSPORTATION. THIS MAP IS UNOFFICIAL AND SHOULD NOT BE USED FOR LEGAL PURPOSES. THE SOUTH DAKOTA DEPARTMENT OF TRANSPORTATION IS NOT RESPONSIBLE FOR ANY ERRORS OR OMISSIONS. THE SOUTH DAKOTA DEPARTMENT OF TRANSPORTATION IS NOT RESPONSIBLE FOR ANY DAMAGES, INCLUDING CONSEQUENTIAL DAMAGES, ARISING FROM THE USE OF THIS MAP.